

EASY | COST-EFFECTIVE | RELIABLE



HIGH HEAD PA DE-WATERING PUMPS

APPLICATION FEATURES

Bearing assembly and shaft

- Provided with hardened shaft sleeve to protect the shaft
- Oil bath bearing arrangement
- Maximum power: 300kW - PR150
: 150kW - PR100

Impeller

- Enclosed impellers to maximise efficiency
- Pump-out vanes on both shrouds
 - Minimises re-circulation
 - Reduces stuffing box pressure
- Efficiencies up to 70%
- Total head up to 140m
- Impeller can be adjusted to maintain maximum efficiency

Seal options

- Centrifugal seal eliminates need for gland service water
- Centrifugal seal reduces sleeve wear and possible bearing contamination
- Optional stuffing box arrangement for high suction head applications

Casing

- Single casing with assembly clamps
- Clamp design allows for rotation of volute
- Volute and flange clamp design for easy maintenance

Design Considerations

BATTLEMAX PR high head de-watering pumps are designed for light slurries and contaminated water high head applications.

PR pumps have high-chrome wet ends with expeller or stuffing box seal arrangements.

Standard Construction and Materials Options

LINERS	High chrome
IMPELLERS	High chrome
GLAND	Steel gland, 14% chrome shaft sleeve
SHAFT SEAL	Packed gland stuffing box or expeller seal

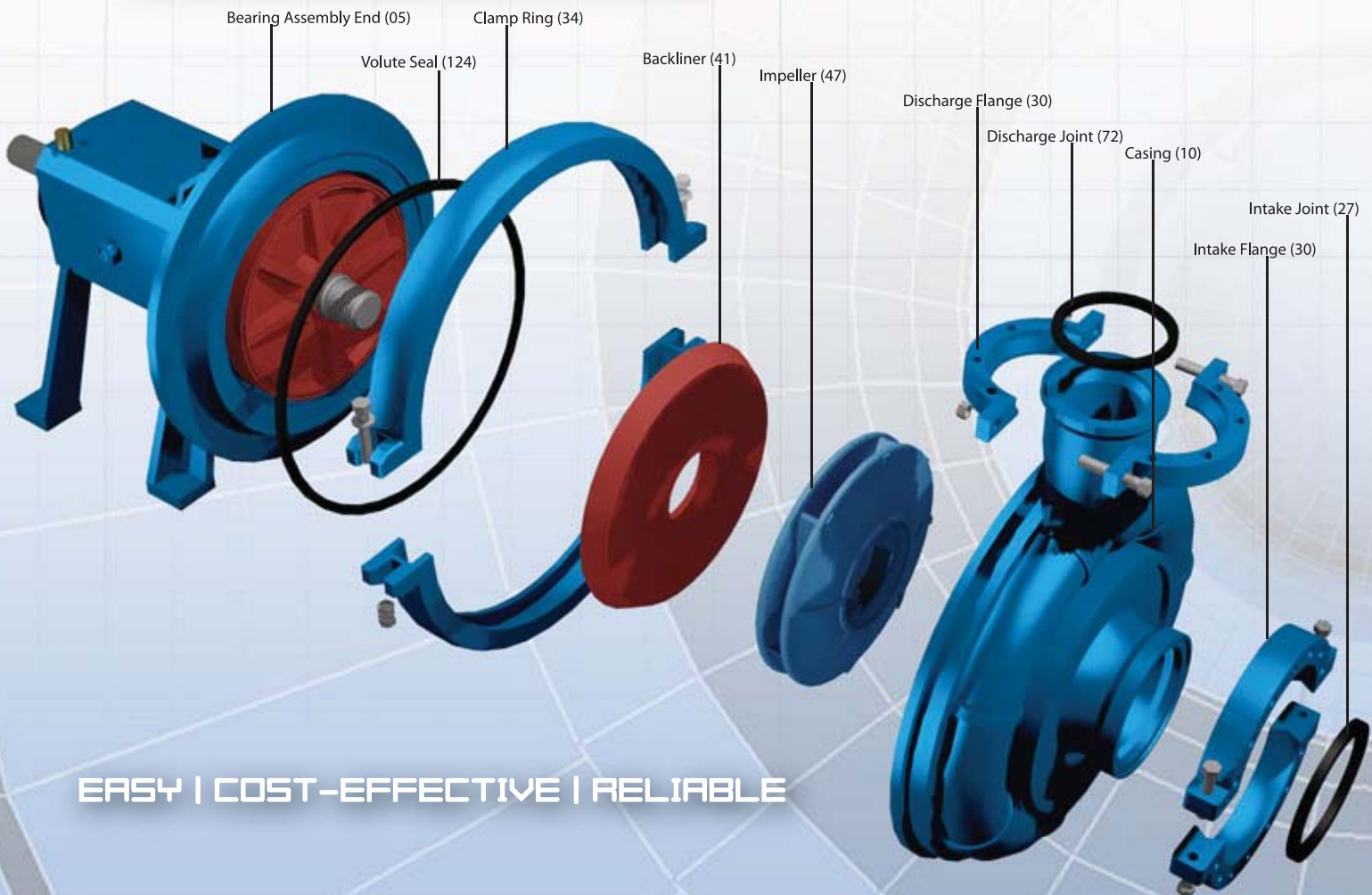

EASY | COST-EFFECTIVE | RELIABLE

STUFFING BOX SEAL ARRANGEMENT

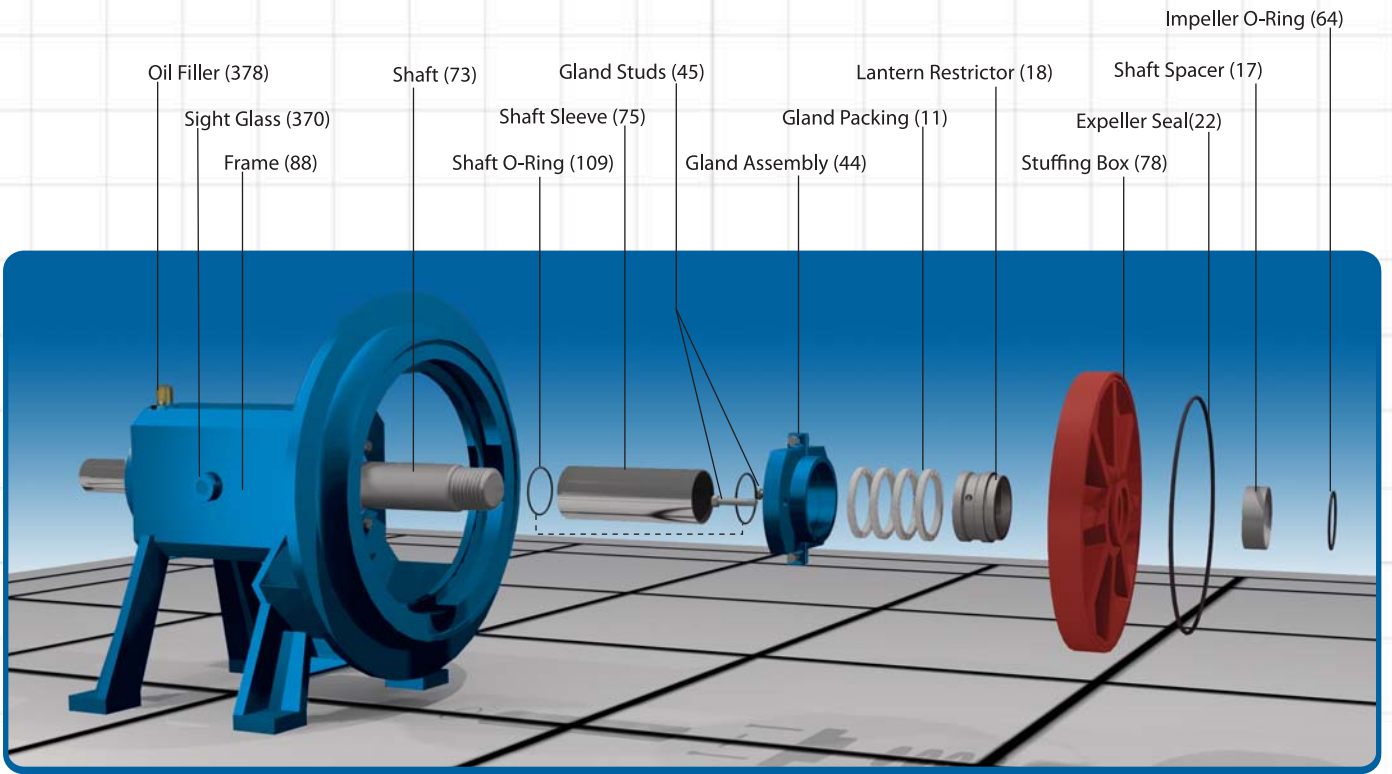

EXPELLER SEAL ARRANGEMENT

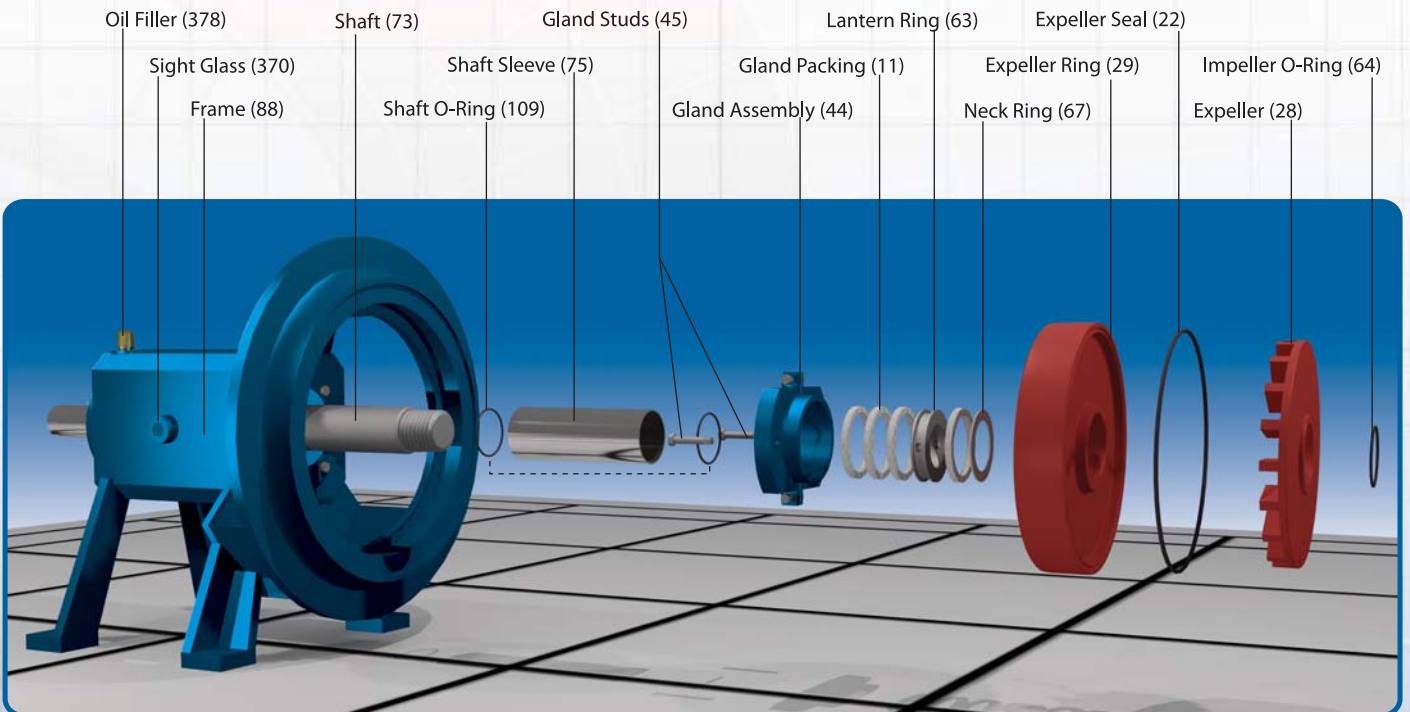

battlemax
HEAVY DUTY SLURRY SOLUTIONS

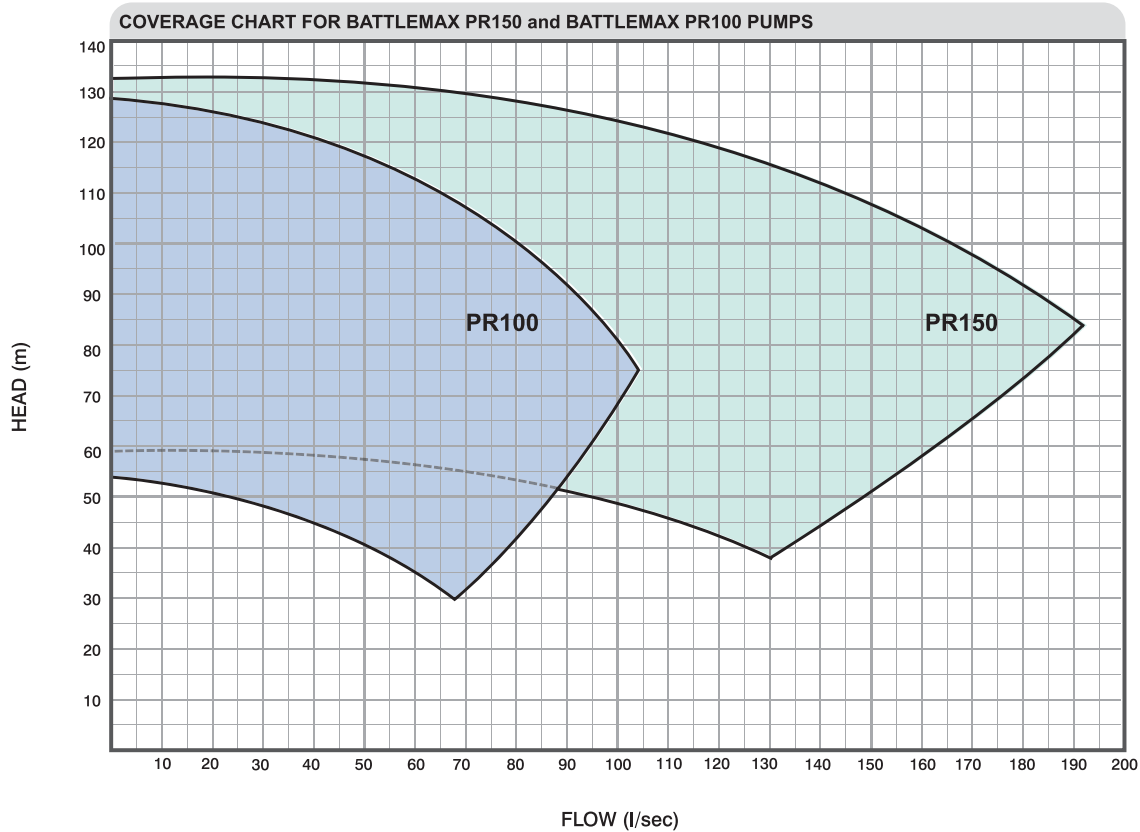

For conventional packed stuffing box and lantern restrictor construction, gland service water must be provided at a minimum of 1 BAR above discharge pressure to ensure positive flow.

Where suction conditions allow, the Battlemax expeller seal can eliminate the need to supply water to the stuffing box. Where high suction pressures or series pumping is required other methods of sealing must be utilised.

Expeller and expeller ring are constructed of Hi-Chrome material. Shaft sleeve material is 14% chrome hardened to protect the shaft from wear.

www.pumpandabrasion.co.za

Tel: 012 666-0904/5 | Fax: 086 617-9407 / 012 666-0906
Email: info@pumpandabrasion.co.za

299 Barolong Street
Icon Industrial Park
Sunderland Ridge, Centurion
P.O. Box 54693
Wierda Park, 0149
Centurion, South Africa

Rustenburg

Rustenburg Warehouse Park
Cnr Van Belkum & Beyers Naude Streets
Rustenburg

Australia

Slurry Technology Group Pty Limited (SLURRYTECH)

Tel: +61 (0)8 9399 7331
Fax: +61 (0)8 9399 7331
Mobile: 0439 094 950
Email: tony@slurrytech.net
Website: www.slurrytech.net
Address: PO Box 860, Armadale, WA 6992

Distributor:

